

Model	A	B	C	D	ØE
RCQ 50.11	130	140	24	74	114

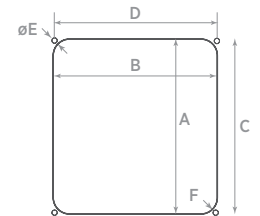

Drilling scheme	A	B	C	D	ØE	F
RC 12.13	117	125	115	123	3	12

## RC 12.13 - 130×140 | 67 m<sup>3</sup>/h

### VENTILATION

- Axial fans supplied with grille and filter;
- High external profile;
- IP44 or IP54 protection degree;
- Quick and functional assembly of the fan on the electrical cabinet through elastic click hooks and gasket pre-installed on the product;
- Maximum operating temperature: +50°C;
- Electrical connection through terminal block;

- Possible installation with screws (provided);
- Ball bearing motor;
- Body made of ABS self-extinguishing material grey RAL 7035;
- Grilles in grey RAL 7032 and 7035, black RAL 9005;
- Easily removable grille to allow quick replacement of the filter;
- Slotted external grilles to allow drainage of condensation;
- In accordance with European Standard EN 60529, EN 60335-2-80.

### TECHNICAL DATA

Model intake	Code	IP Grade	Voltage (V)	Frequency (Hz)	Colour grille	Flow rate (m <sup>3</sup> /h) with filter	Flow rate (m <sup>3</sup> /h) without filter	Power (W)	Nom. Curr. (A)	Noisiness dB(A) <sub>1m</sub>	Weight Kg
RC 12.13	0095532	IP44	220-240	50/60	GREY RAL 7032	50	67	17	0,11	38	0,6
RC 12.13	0095535	IP44	220-240	50/60	GREY RAL 7035	50	67	17	0,11	38	0,6
RC 12.13	0095505	IP44	220-240	50/60	BLACK RAL 9005	50	67	17	0,11	38	0,6
RC 12.13	0095932	IP44	110-120	50/60	GREY RAL 7032	50	67	17	0,22	38	0,6
RC 12.13	0095935	IP44	110-120	50/60	GREY RAL 7035	50	67	17	0,22	38	0,6
RC 12.13	0095905	IP44	110-120	50/60	BLACK RAL 9005	50	67	17	0,22	38	0,6
RC 12.13	0090132	IP54	220-240	50/60	GREY RAL 7032	30	67	17	0,11	38	0,6
RC 12.13	0090135	IP54	220-240	50/60	GREY RAL 7035	30	67	17	0,11	38	0,6
RC 12.13	0090105	IP54	220-240	50/60	BLACK RAL 9005	30	67	17	0,11	38	0,6
RC 12.13	0090032	IP54	110-120	50/60	GREY RAL 7032	30	67	17	0,22	38	0,6
RC 12.13	0090035	IP54	110-120	50/60	GREY RAL 7035	30	67	17	0,22	38	0,6
RC 12.13	0090005	IP54	110-120	50/60	BLACK RAL 9005	30	67	17	0,22	38	0,6

### FLOW CHARTS

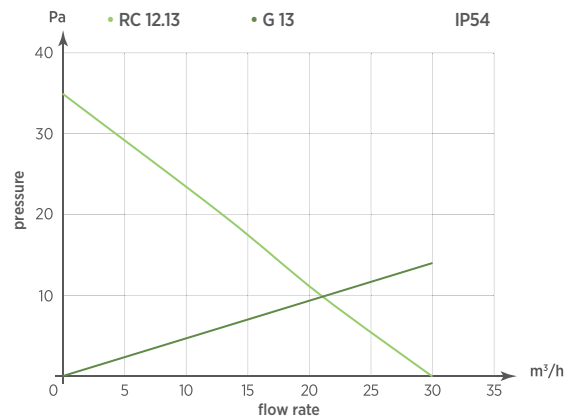
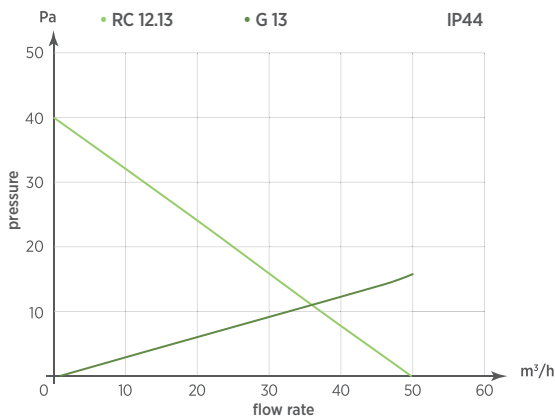

### ACCESSORIES: SEE PAGE 22 AND 44



Grilles



Thermostats



Hygostat