

Model	A	B	C	D	E
TXQ 550	308×308	270×270	135	50	4-M6

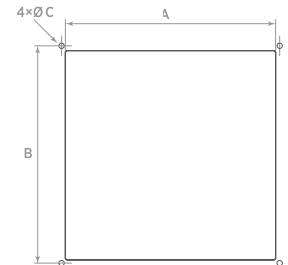

Drilling scheme	A	B	Ø C
TXQ 550	212	230	6,5

TXQ 550

AERATION

- Roof exhaust fan to extract air directly outside;
- Ball bearing motor;
- IP24 protection degree;
- IP44 side cabinet protection degree;
- Maximum air temperature 60°C;
- Quick and functional installation from inside the cabinet
- Supply cable (0,75 mt) included;
- Energy saving and reduced noise;

- Painted steel body complete with plastic cover, Grey colour RAL 7035;
- Safety protection grille;
- Ball bearing motor impeller self-cleaning backward curved blades;
- Adjustable speed through industrial controllers RGM2 or RGE (optional);
- Necessary to provide for installation an air intake grille in the lower part of the control cabinet;
- In accordance with Standard EN 60335-2-80.

TECHNICAL DATA

Model	Code	Voltage (V)	Frequency (Hz)	Flow rate (m³/h)	Power (W)	Nom. Curr. (A)	IP Grade		Noisiness dB(A) _{1m}	Weight (Kg)
							roof fan	side cabinet		
TXQ 550	0075800	230	50/60	450/500	80	0,35	IP 24	IP 44	54	3,5

FLOW CHARTS

