

# TXQ M 1500

## AERATION

- Roof exhaust fan to extract air directly outside;
- IP24 protection degree;
- IP44 side cabinet protection degree;
- Maximum air temperature 60°C;
- Quick and functional installation thanks to the electrical connection and mounting from the inside of the control cabinet;
- Energy saving and reduced noise;

- Painted steel body grey RAL 7035;
- Safety protection grille;
- Ball bearing motor impeller self-cleaning backward curved blades;
- Adjustable speed through industrial controllers RGM2 or RGE (optional);
- Necessary to provide for installation an air intake grille in the lower part of the control cabinet;
- In accordance with Standard EN 60335-2-80.

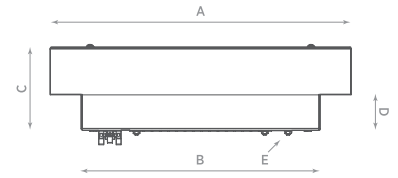

Model	A	B	C	D	E
TXQ M 1500	430x480	350x400	110	50	6-M4
TXQ M 1500 CA	430x480	350x400	110	50	6-M4

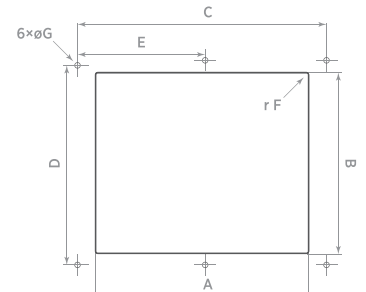

Drilling scheme	A	B	C	D	E	r	F	øG
TXQ M 1500	325	275	370	320	185	5	4,5	

## TECHNICAL DATA

Model	Code	Voltage (V)	Frequency (Hz)	Flow rate (m³/h)	Power (W)	Nom. Curr. (A)	IP Grade		Noisiness dB(A) <sub>1m</sub>	Weight (kg)
							roof fan	side cabinet		
TXQ M 1500	0075830	230	50/60	1470/1560	150	0,75	IP 24	IP 44	57	7,5
TXQ M 1500 CA	0075860	(Ventilation hood without motor)		-	-	-	IP 24	IP 44	-	4,5

(\* ) 110 V version available on request

## FLOW CHARTS

